



Tube Technologies Inc.
 1555 Consumer Circle
 Corona, CA 92880
 (951) 371-4878
www.ttiexhaust.com

O.E. STYLE TAILPIPE HANGER RECEPTACLES

- Included with Tailpipes.
- Includes Hardware
 - Part # TPH-AB2530

1966-1967 "B"-body Exhaust System

- 2.5" system – part # XB25HW6667
- 3.0" system – part # XB30HW6667

DYNOMAX SUPER TURBO MUFFLERS
 Comes standard with TTI systems.

- 2.5" - Overall length 25.5" / Part # 17748
- 3.0" - Overall length 27" / Part # 17769

X-PIPE ASSEMBLY

- with width adjusting slip-connectors.
- (2) S/S Band Clamps
 - (4) 3/8" Heavy-Duty U-bolt Clamps

OVER-AXLE TAILPIPES
 with welded hangers.

MUFFLER BODY BRACKETS

If your application is not equipped with Muffler Body Brackets, a set will be required.

- Sold separately - Part # E2530BB-2

MUFFLER HANGERS

Included with system.

- 2.5" Part # MH-B25HA
- 3.0" Part # MH-B30HA

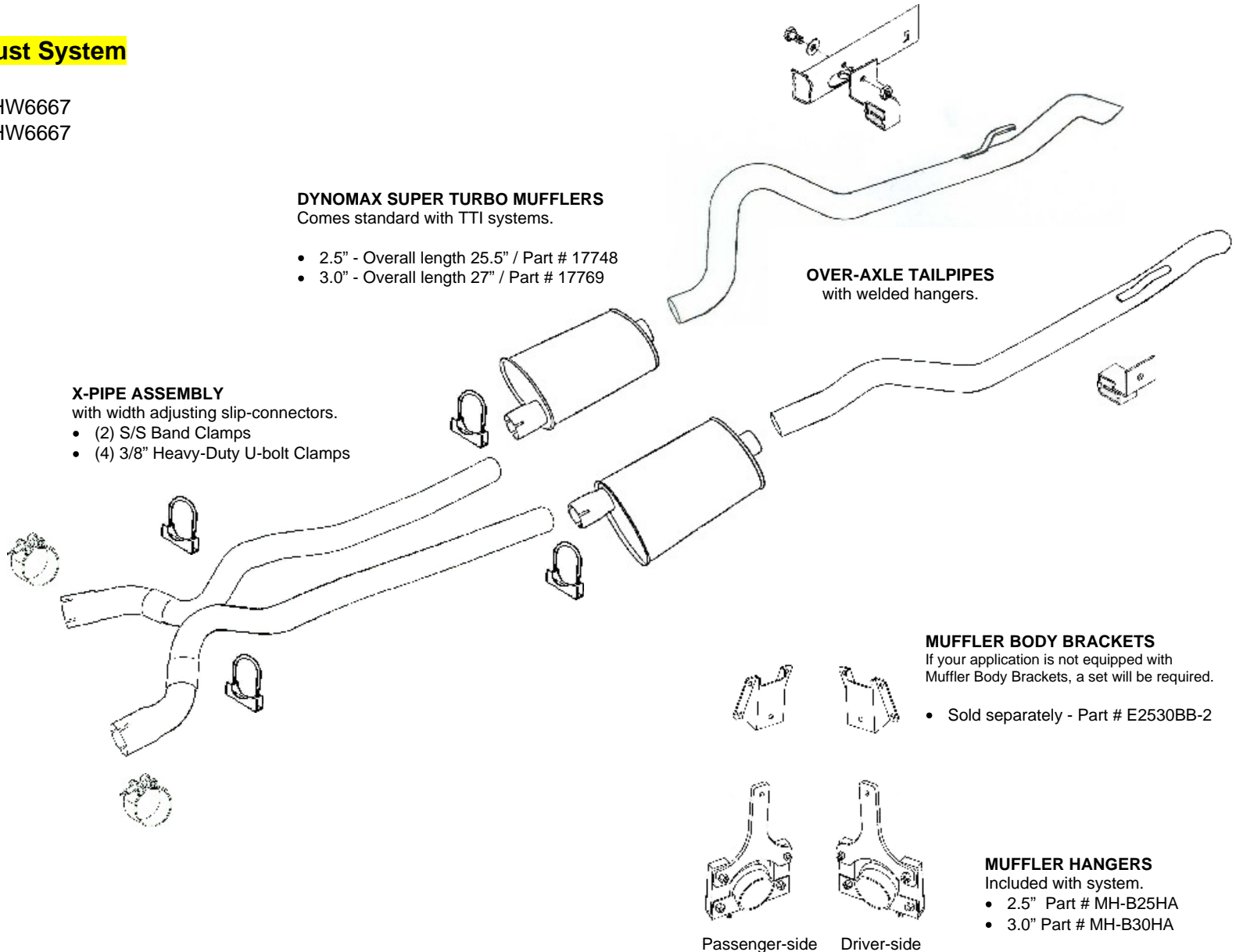

Passenger-side Driver-side