



Tube Technologies Inc.
 1555 Consumer Circle
 Corona, CA 92880
 (951) 371-4878
www.ttiexhaust.com

1968-1970 "B"-body Exhaust Systems

- 2.5" system – part # XB25HW870
- 3.0" system – part # XB30HW870

O.E. STYLE TAILPIPE HANGER RECEPTACLES
 Included with Tailpipes.
 • Includes Hardware
 • Part # TPH-B2530

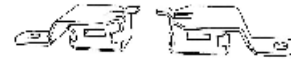

DYNOMAX SUPER TURBO MUFFLERS
 Comes standard with TTI systems.

- 2.5" - Overall length 25.5" / Part # 17748
- 3.0" - Overall length 27" / Part # 17769

OVER-AXLE TAILPIPES
 with welded hangers.

X-PIPE ASSEMBLY
 with width adjusting slip-connectors.
 • (2) S/S Band Clamps
 • (4) 3/8" Heavy-Duty U-bolt Clamps

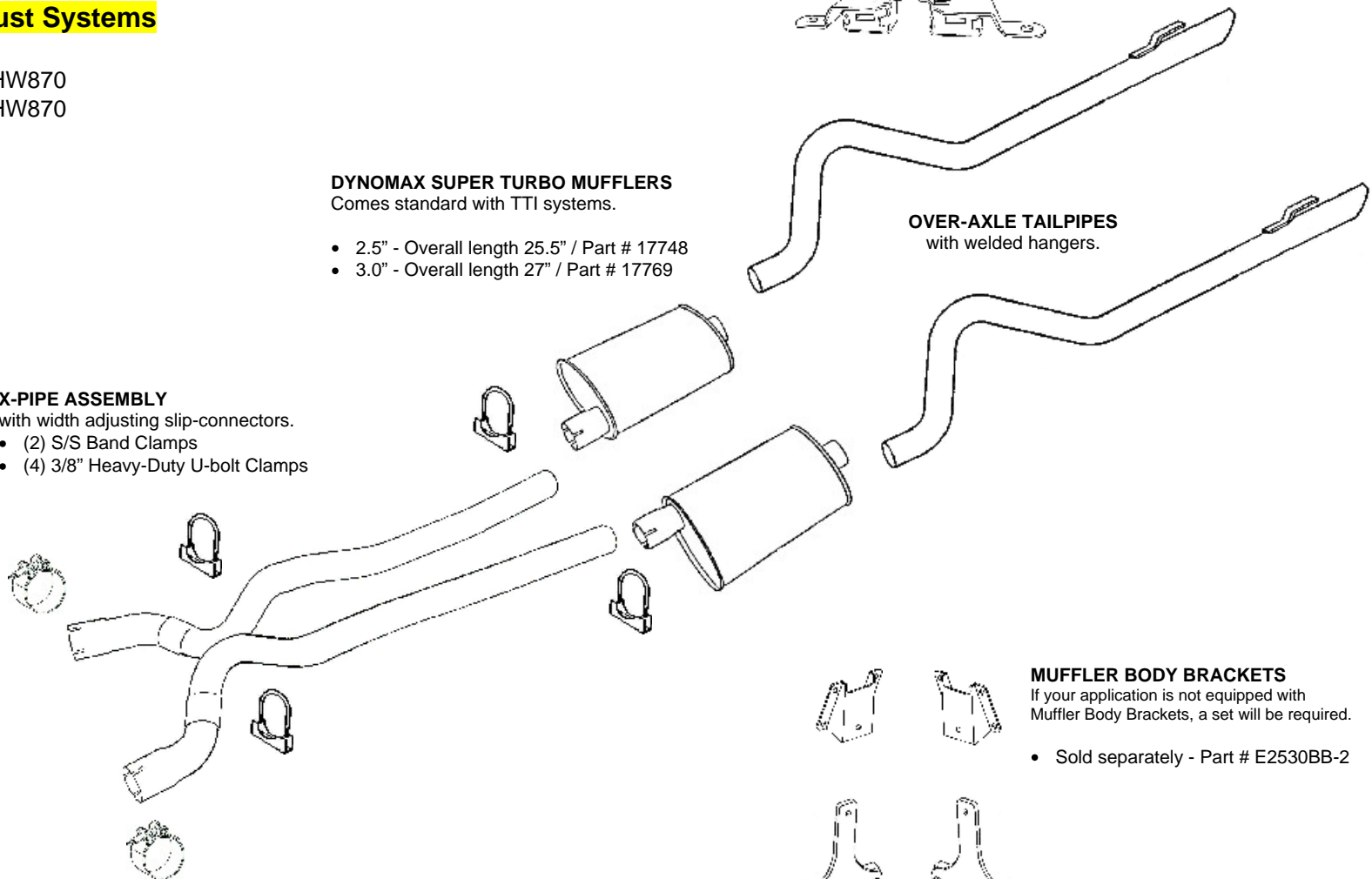

MUFFLER BODY BRACKETS
 If your application is not equipped with Muffler Body Brackets, a set will be required.

- Sold separately - Part # E2530BB-2

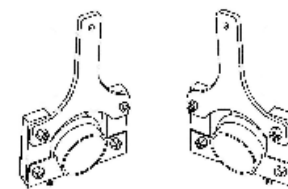
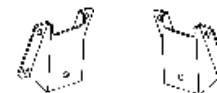

Passenger-side Driver-side

MUFFLER HANGERS
 Included with system.
 • 2.5" Part # MH-B25HA
 • 3.0" Part # MH-B30HA